



TO LET

London Road, Isleworth, TW7 4BX
£2,500 Per Calendar Month

DBK
ESTATE AGENTS

- Available To Rent Immediately! ▪ Spacious Apartment
- Second Floor ▪ Four Bedrooms
- Modern Fitted Kitchen ▪ Reception Room
- Newly Refurbished Bathroom ▪ Additional Shower Room/ WC
- Close to many Amenities ▪ Stone Throw Away From Isleworth Station

GROUND FLOOR
861 sq.ft. (80.0 sq.m.) approx.

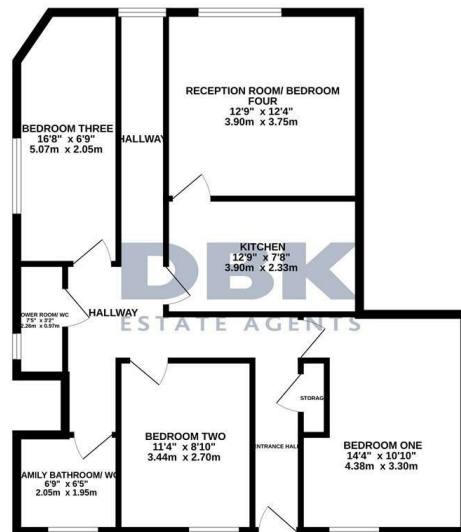

TOTAL FLOOR AREA : 861 sq.ft. (80.0 sq.m.) approx.
Whilst every attempt has been made to ensure the accuracy of the floorplan contained herein, measurements of areas, volumes, sizes and any other items are approximate and no responsibility is taken for any error, omission or misstatement. This plan is for illustrative purposes only and should be used as a guide to the prospective purchaser. The services, systems and appliances shown have not been tested and not guaranteed as to their operability or efficiency can be given.
Made with Metaplan 12/2023

THE PROPERTY

Available to rent immediately, this spacious second-floor apartment offers generous and well-presented accommodation, ideal for families or sharers. The property comprises four well-proportioned bedrooms, a bright reception room, and a modern fitted kitchen designed for practical everyday living.

The apartment further benefits from a newly refurbished bathroom, along with an additional shower room and WC, providing convenience and flexibility for multiple occupants.

The property is ideally positioned in the heart of Isleworth, within the London Borough of Hounslow. The property benefits from a wide range of local shops, cafés, and everyday amenities along London Road, all within easy walking distance.

Isleworth Station is just a short walk away, providing excellent transport links into central London and surrounding areas. The location also offers convenient access to neighbouring areas such as Brentford, Hounslow and Richmond, making it ideal for commuters and residents alike.